



USER'S MANUAL

Golf Caddy

Follow M8



SUMMARY

1	General Cautions	3
2	Packing list	4
2.1	Follow M8 Package Contents	4
3	Main parts	5
4	Assembly instruction	6
5	Battery Use	8
5.1	Recommendation for battery storage	8
5.2	Battery charging	8
6	Control function	11
6.1	Main control / Display Function	11
6.2	Display Function	12
6.3	Remote control	15
6.3.1	Remote control synchronizing	20
6.4	Follow Me mode	22
6.5	USB port	25
7	Mobile device APP	26
7.1	Download APP - Connect procedure	26
7.2	Main Page	27
7.3	Virtual remote control	28
7.4	Settings page	29
8	Maintenance	31
8.1	Battery Maintenance	31
8.2	Troubleshooting guide	33
9	Technical data	36



I General Cautions

FIRST USE



- Read the user manual carefully before using the caddy.
- Before using the caddy for the first time, fully charge the battery for at least 5 hours.
- The caddy is not designed to go up or down steps or curbs. Improper use may cause irreversible damage to the caddy.
- When using the remote control of the caddy, remember that the operation of the remote can be disturbed by radio or magnetic waves present in the area, always keep an eye on the movements of your caddy.
- Do not leave the caddy or battery exposed to rain.
Our caddy is designed to be water resistant but not to be immersed in water or washed with a hose or pressurized water jet.
- Do not immerse or expose the battery, charger or remote control to direct jets of water.

DANGER!!



- Only charge the battery in a well-ventilated area and under the supervision of someone. **DO NOT CHARGE THE BATTERY OVERNIGHT OR WHEN YOU ARE OUT OF THE HOME.**
- Do not use battery chargers other than the one supplied.
- Do not replace the supplied battery with a non-original spare part.
- Do not modify the caddy's electrical circuits or alter its factory performance settings.
- Only use the caddy in a private area, closed to traffic.
- Do not allow the use of the caddy by children under 12 years of age.
- Do not use the caddy for anything other than its intended purpose (transport of a bag for clubs).
- Do not use the caddy to transport people, animals or things.
- Do not exceed the maximum capacity of the caddy (65 lbs).



2 Packing list

2.1 Follow M8 Package Contents

1 Caddy main frame	1 Battery charger
2 Rear Wheels	1 Cup holder
1 Remote control (Batteries included)	1 GPS/phone holder
1 Remote control clip	2 Hubcaps
1 Battery pack	1 USB charging cable
1 Umbrella holder	1 Tool kit (screw driver- Allen wrench)





3 Main parts





4 Assembly instruction

1. Unpack all items and check inventory.
2. Assemble the wheels to the caddy body using the appropriate bolts and washers provided (6 each wheel). For tightening the bolts, use the Allen wrench included with your caddy.
3. After properly tightening all the bolts, apply the hubcaps to the wheels, pressing until you hear a "click".

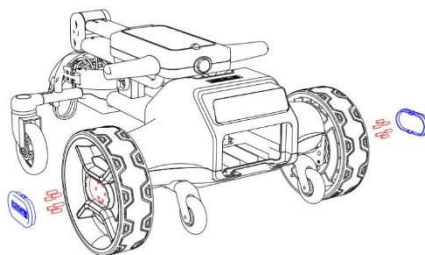

WHEELS ASSEMBLY



- During the wheel assembly, make sure to tighten the bolts in an alternating pattern to ensure an optimal fit.
- Do not overtighten the bolts, as you could strip the bolt or break the wheel. All bolts are equipped with threadlocker to prevent them from loosening during use.

4. After charging the battery for at least 5 hours before the first use, insert it into the designated compartment.





INSTALLING AND REMOVING THE BATTERY



- The first few times you insert the battery into the caddy, you may need to apply some force to ensure it is fully seated in its compartment. Use both thumbs to press the battery into place until it is flush with the body of the caddy.
- If the battery does not fit into its compartment, check that the contact pins inside the caddy body are not bent and that there are no obstructions in the contact pin slots on the back of the battery.

5. Bring the tiller into the operating position (The tiller can be adjusted to 4 different height positions). Specifically, unlock the upper part of the tiller by operating the adjustment lever (**Fig. A**) and secure the lower part of the tiller using the magnetic mounting plate (**Fig. B**). Adjust the desired height of the tiller using the adjustment knob (**Fig. A**).
6. Bring the anti-tip wheels into the operating position by opening them outward from the caddy and ensuring that the locking device is engaged

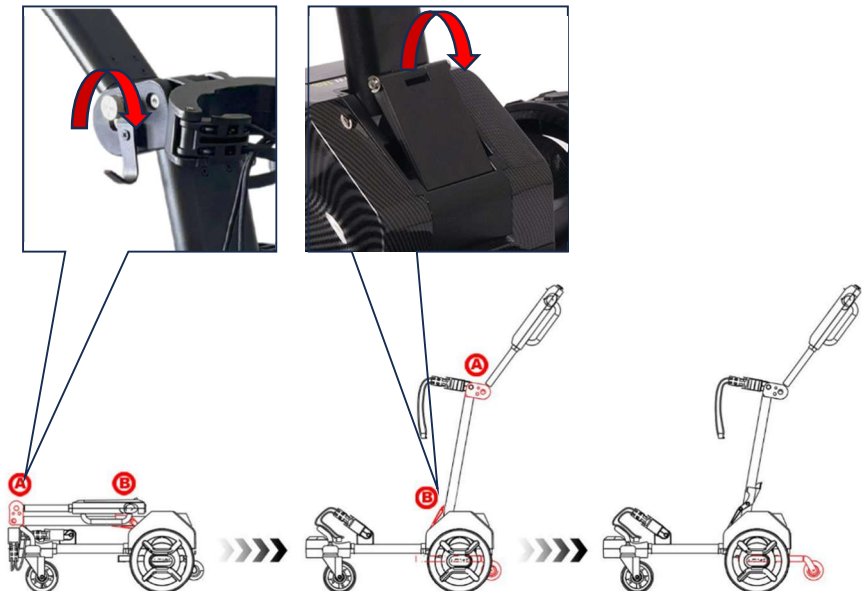



TILLER POSITION - ANTI TIP WHEELS



- Before using the caddy, make sure the tiller is properly locked.
- Do not lift the caddy by the tiller or use the tiller to lift the caddy, as you could irreparably damage your caddy.
- For added safety and stability of the caddy during use, always deploy the anti-tip wheels.

5 Battery Use

5.1 Recommendation for battery storage

If you do not use the caddy for an extended period of time (e.g., during the winter season), it is recommended to disconnect the battery from the caddy and store it in a location protected from water, humidity, and dust, after fully charging it. Before using the battery again, perform a full recharge.

5.2 Battery charging

1. Make sure the caddy is turned off, then remove the battery from the caddy by placing your hand at the bottom of the battery and pulling it towards you.

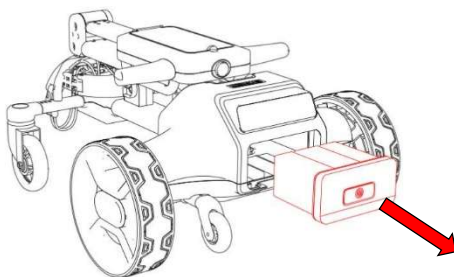

2. Connect the battery to the provided charger using the appropriate jack located to the right of the power button (under the rubber protective cover).



3. The charger body has a charge status indicator light. If the LED is red, it means the battery is not fully charged yet. A green LED indicates that the battery is fully charged.



4. If the battery is completely discharged, a full charging cycle takes about 6 hours.
5. The battery is equipped with an integrated BMS (Battery Management System) that stabilizes the charge once complete, so it is not necessary to immediately disconnect the charger once charging is finished. However, it is always recommended to disconnect the charger as soon as possible after charging is complete.



FIRE - EXPLOSION



- **Never leave the battery unattended while charging. The battery is equipped with a safety BMS that prevents overcharging. However, it is good practice to stay nearby during the charging process and, if possible, avoid charging the battery overnight.**
- **If you notice any swelling on the battery, immediately disconnect the battery charger and place the battery in an outdoor area. Then contact Green Eagle Golf customer service.**

BATTERY CHARGING TIPS



- **Always remove the battery from the caddy during charging. Failing to do so may cause inaccurate battery level readings on the caddy display.**
- **Connect the charger only to standard 110V residential power outlets.**



6 Control function

6.1 Main control / Display Function



1 - POWER BUTTON

Press the button to turn your caddy ON, the LCD display will turn on.

Holding down the button for 2 seconds will turn your caddy OFF.

2 - CONTROL KNOB

- When the caddy is turned on, press the knob once to activate the marching driving mode. The icon Rif. 7 will appear on the caddy's display to indicate that the mode has been activated.



- Turn the knob clockwise to increase the caddy's driving speed, and turn it counterclockwise to decrease the speed.
- When the caddy is moving in marching mode, press the knob once to stop the caddy and return to manual driving mode.
- Quickly press the knob twice to activate the caddy's movement lock. The activation of the lock is indicated by the 'lock' icon (Rif. 8) lighting up on the caddy's display. To unlock the caddy, quickly press the knob twice again.

6.2 Display Function

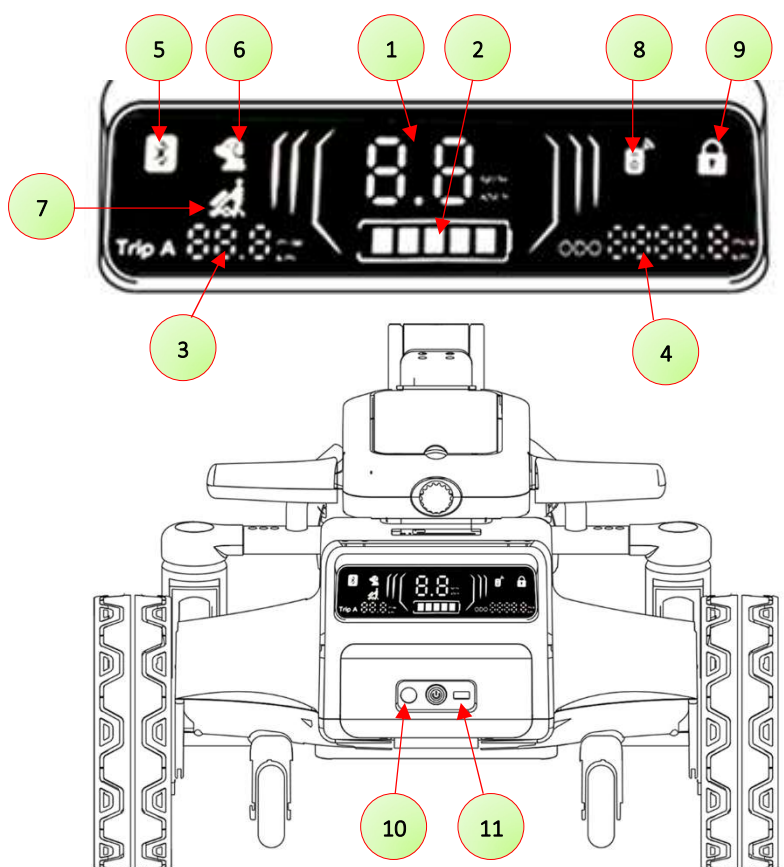



1 – SPEED INDICATOR

The displayed value can be shown in either miles per hour or kilometers per hour. You can set the preferred unit of measurement in the setting page of smartphone app.

2 – BATTERY STATUS

The icon indicates the caddy's battery charge status.

- **No bar displayed and blinking battery signal**- Battery fully discharge
- **Only the red bar is on** – 20% remaining charge; the battery needs to be recharged.
- **Red bar + one (1) blue bar** – 40% remaining charge.
- **Red bar + two (2) blue bars** – 60% remaining charge.
- **Red bar + three (3) blue bars** – 80% remaining charge.
- **Red bar + four (4) blue bars** – 100% charge.

LOW BATTERY



- **Always check the actual battery charge level through the smartphone app.**
- **If you run out of battery during a game, you can turn off the caddy and push the caddy manually.**

3 – TRIP A

Indicates the distance traveled with the caddy from the moment it is turned on to the moment it is turned off.

4 – ODO

Indicates the distance traveled with the caddy from the first use. The odometer can only be reset by restoring the caddy to its factory settings.

5 – BLUETOOTH®

The flashing light indicates that the caddy is in pairing mode. The solid light indicates that the caddy is successfully paired with a mobile device (smartphone or tablet).



6 – FOLLOW MODE

The active icon shows that the Follow Me mode is active. In this mode, the caddy will follow the remote control according to the settings defined via the mobile app.

7 – MARCHING MODE

The active icon shows that the marching mode is active. In this mode you can control the caddy's speed through the knob on the tiller,

8 – REMOTE CONTROL

The active icon shows that the remote control (physically or via the mobile application) is active. In this mode, you can control the caddy using the joystick on your remote control or on your mobile device.

9 – PARKING BRAKE

The active icon shows that the caddy's wheel lock device is active. Quickly press the knob on the tiller twice (2) to activate or deactivate the brake.

10 – USB PORT

Through the USB port, it is possible to recharge the remote control's battery in case of emergency or your mobile devices (smartphone or tablet).

11 – CHARGING PORT

The charging socket allows you to connect the battery charger supplied with the caddy and charge the battery.

DANGER



- To recharge the caddy's battery, use only the battery charger provided.
- Connect the battery charger to a 110V power outlet. Do not connect the battery charger to other types of power sources.
- Do not recharge the battery at night or when no one is present to intervene in case of overcharging, smoke generation, or fire.



6.3 Remote control

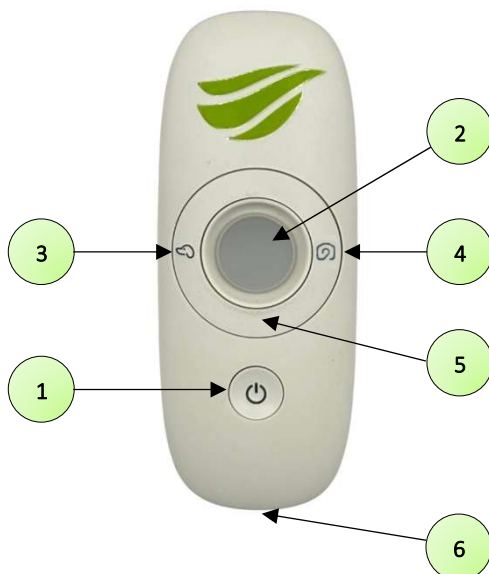

1 - POWER ON/OFF

Pressing the button turns the remote control ON or OFF. When the remote control is on and paired with the caddy, indicator (rif. 8) will light up on the display and the blue indicator light (6) on the remote will turn on.

2 - JOYSTYCK

- **REMOTE CONTROL MODE:** The joystick allows you to control the caddy's movement in all directions. The movement commands are momentary, meaning that releasing the joystick will stop any movement immediately.

JOYSTYCK SENSITIVITY



- It is recommended to practice using the joystick in an area free of obstacles and people. Additionally, the caddy's steering sensitivity can be adjusted via the smartphone app.



- **CRUISE CONTROL MODE:**

By quickly pushing the joystick forward twice (2), the 'Cruise Control' mode is activated. In this mode, the caddy will move forward autonomously at one of three preset speeds (speed settings can be adjusted via the smartphone app). To switch to the next speed level, simply push the joystick forward once. While in this mode, the user only needs to control the caddy's direction—left or right—using the joystick. To stop the caddy's movement, either pull the joystick backward or press the ON/OFF button on the remote.

Remote Control Vibration



- **The remote control is equipped with a vibration system that alerts the user to a potential loss of communication between the remote control and the golf caddy. When the signal strength decreases, the remote control will begin to vibrate. As the vibration frequency increases, the signal becomes weaker, indicating a higher risk of losing control of the golf caddy.**

Loss of Remote Signal



- **If the remote control begins to vibrate at a very high frequency, stop the caddy immediately and move closer to restore proper communication between the remote control and the golf caddy. If the signal has already been lost, turn the remote control off and back on to reestablish the connection.**



3 – FOLLOW ME

REMOTE EXPOSURE

- When using Follow Me mode, to ensure the caddy functions properly, the remote control must be kept clearly exposed, ideally positioned at waist level on the side or back of the body using the provided belt clip. Follow Me mode also works if the remote is kept in a pocket; however, the signal exchange between the remote and the caddy may be less accurate.



IMPORTANT NOTE:

The Follow Me mode works through the exchange of electromagnetic signals between the caddy and the remote. All electromagnetic signals can occasionally be subject to interference, which may cause the caddy to temporarily lose orientation. If this happens, stop the caddy's movement using the ON/OFF button (1) on the remote or the Follow Me mode activation button on the remote (3).

After that, reposition the remote at waist height on the back side of your body to optimize communication between the remote and the caddy, and set the following distance to between 2 and 3 meters.

Pressing the button activates the 'Follow Me' mode. Activation of the function is indicated by indicator (rif. 6) lighting up on the caddy's display and by the green indicator light (6) on the remote.. When this mode is active, the caddy follows the remote control, adjusting its speed to maintain the preset distance (distance settings can be configured via the smartphone app). The caddy will automatically stop when it no longer detects movement from the remote.

Pressing the button again deactivates the 'Follow Me' function, allowing you, for example, to take a club from your bag and make a shot.

When the caddy is stationary, you can use the 'Follow Me' button to call the caddy back. Simply pressing the button will make the caddy come toward you and stop at the preset distance. If you continue walking, the caddy will follow you.



DANGER



- The caddy is not designed to detect obstacles or people during its movement. It is the user's responsibility to ensure that the path is clear of obstacles and people.
- Using the 'Follow Me' function in narrow spaces could result in collisions with objects, curbs or people and may damage your caddy.

REMOTE CONTROL POSITION



- When using the 'Follow Me' mode, always make sure to keep the remote control attached at waist level to your belt or the back pocket of your pants (using the included clip). For proper operation, your body should never be positioned between the caddy and the remote control.

4 – RECORDING MODE

By pressing the button (4) on the remote while the smartphone app is open on your device, a video recording will automatically start, allowing you to capture your shots and review them to correct any mistakes. Pressing the button a second time will automatically stop and save the recording.

RECORDING MODE



- The recording button only works if your mobile device is connected to the caddy via Bluetooth and the app is open on the mobile device's homepage.



5 – CHARGING PORT

When the power button (I) on the remote control flashes red and the remote vibrates frequently, the battery level is low and the remote needs to be recharged.

You can charge your remote control using the included cable via the USB port on the caddy, or with any standard charger with output voltage 5V and current output < 3Amp. The remote's battery level is displayed in the smartphone app.

REMOTE CONTROL CHARGE

- To charge the remote control, use the USB Type-C cable provided with the caddy. The output of the charger used must be: 5V <3 Ampere



IF YOU NOTICE THAT THE REMOTE CONTROL IS NOT CHARGING, TRY USING A DIFFERENT POWER ADAPTER, AS THE ONE YOU ARE USING MAY NOT PROVIDE ENOUGH CURRENT TO CHARGE THE REMOTE. IF THIS DOES NOT RESOLVE THE ISSUE, TRY REPLACING THE CHARGING CABLE AND CHECK THAT THE REMOTE CHARGES PROPERLY BY MONITORING THE BATTERY STATUS THROUGH THE SMARTPHONE APP.

REMOTE CONTROL CHARGE



- It is recommended to charge the remote control at least every two rounds of play, or alternatively, to check its battery level before starting a new round.



6.3.1 Remote control synchronizing

If the caddy does not respond to the remote control, it may need to be resynchronized.

1. Scan the follow QR code to Download the mobile device APP.



2. Enable the Bluetooth on your device
3. Turn ON your caddy then open the APP.
4. Connect your caddy with the APP. if the name of your caddy doesn't appear in the device list, press "Search Again".
5. With the remote in OFF status, press and hold the **Follow Me** button and the **Camera** button.





6. While continuing to hold the first two buttons In the APP main page click on "Click here to pair"

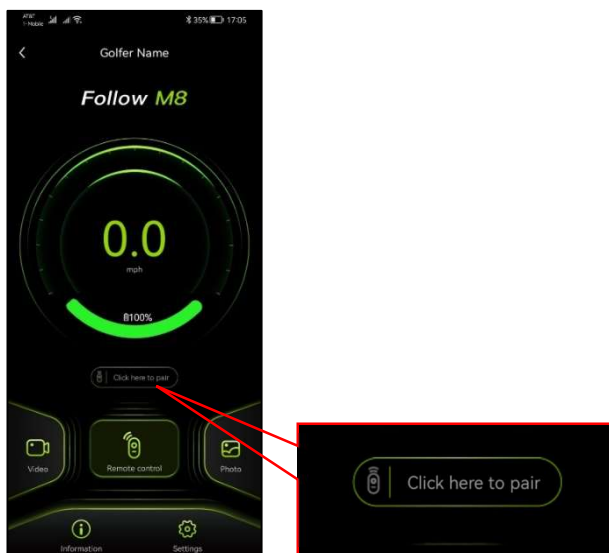

7. While continuing to hold the first two buttons, press and hold the **Power button** on the remote control for at least 3 seconds. Once pairing is successful, the remote will vibrate rapidly.



8. The caddy and remote control are now synched.



6.4 Follow Me mode

PLEASE READ CAREFULLY BEFORE USE



- **Please read the following paragraph carefully to fully understand the correct use of your caddy's Follow Me mode. This will allow you to enjoy the caddy's full functionality while avoiding potential accidents or damage to property or people.**

For the proper use of the Follow Me mode on your Follow M8, it is important to understand that this technology functions accurately and reliably only when there are no obstacles (such as people or objects) between the remote control and the caddy.

The caddy "communicates with" and follows the remote control using ultra-wideband (UWB) radio wave technology. This signal can be disrupted by the presence of objects or people between the transmitter (the remote control) and the receiver (the follow radar located at the front of the caddy). For this reason, it is always recommended to maintain a clear line of sight between the remote and the caddy when using Follow Me mode.

To use the Follow Me mode correctly, please follow these guidelines:

- Activate Follow Me mode while keeping the remote pointed toward the caddy
- When Follow Me is active, always keep the remote on the back side of your body, such as clipped to your back pocket or waistband, to maintain a clear line of sight between the remote and the caddy
- Never place your body between the remote and the caddy
 - For example, do not attach the remote to the front of your body
 - Do not walk backwards while the remote is clipped to the back of your waist
 - These actions may interfere with the signal and cause the caddy to veer in the wrong direction



CORRECT USE OF THE FOLLOW ME MODE



INCORRECT USE OF THE FOLLOW ME MODE





When calling the caddy from a distance (for example, after taking a shot on the green), make sure it is no more than 30 yards from your position

- Keep the remote pointed toward the caddy until it locks onto the signal
- Do not use Follow Me mode when walking between fixed obstacles or people, or when crossing narrow paths, walkways, or bridges over water



RECALL DISTANCE



- The 30-yard indication for the maximum recall distance of the golf caddy is a suggested distance to ensure the correct functioning of this mode. It is also possible to recall the golf caddy from a greater distance, but malfunctions may occur.



6.5 USB port

On the left side of the caddy's power button, there is a USB port designed for emergency charging of the remote control or mobile devices

NOTE: Using the USB port to recharge electrical devices decreases battery autonomy.



USB CHARGING PORT



- If the caddy's battery level is particularly low, the USB charging port will automatically be disabled to preserve the caddy's operating autonomy.



7 Mobile device APP

7.1 Download APP - Connect procedure

1. Scan the follow QR code to Download the mobile device APP (The app can be downloaded on all Android and iOS mobile devices).



2. When you open the app, the following screen will appear (only if the caddy has never been connected to your device before).
AFTER TURNING ON THE CADDY AND ENABLING BLUETOOTH ON YOUR DEVICE, tap the **"Search Again"** button to search for the caddy, then tap **"Connect"** to pair the caddy with your device.

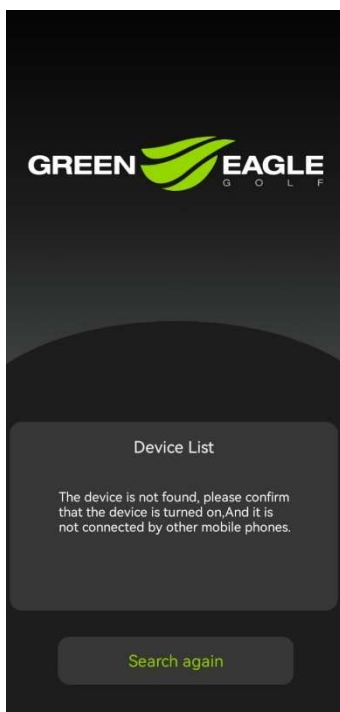

7.2 Main Page

3. If the caddy has been successfully connected to your device, the app's main screen will appear. if not, please repeat the connection process.

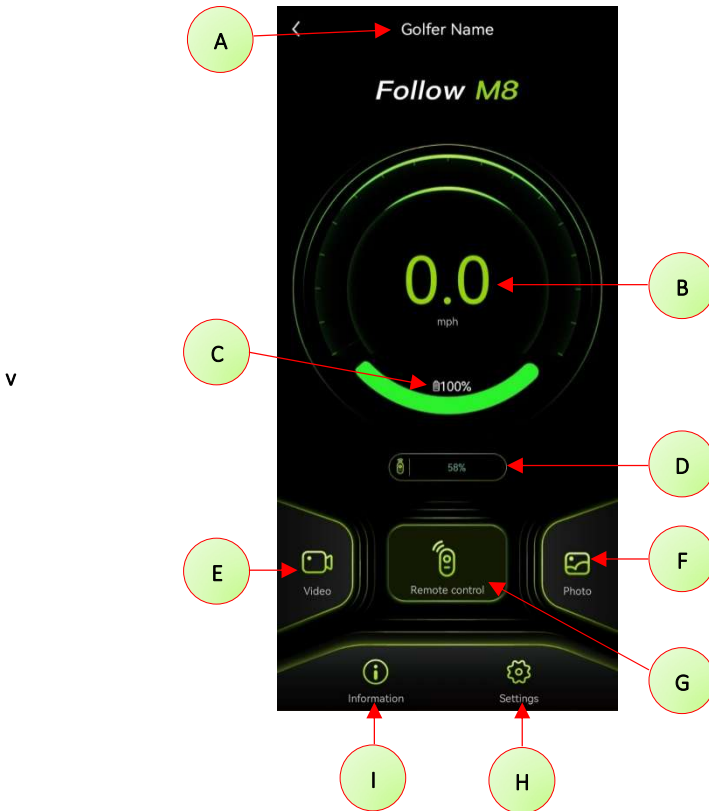

- A. **Caddy or Owner Name** – This field can be edited in the "**Settings**" page (H).
- B. **Caddy real time speed**, displayed in kilometers per hour (km/h) or miles per hour (mph).
The unit of measurement can be changed in the "**Settings**" page (H).
- C. **Caddy battery charge percentage**.
- D. **Remote control battery charge percentage** If the caddy's remote control is turned off, the battery status icon will be replaced by the icon for pairing the remote control with the caddy.



- E. **Click on the icon activates the device's camera** to start recording a video.
- F. **Clicking on the icon opens the device's photo gallery.**
- G. **Clicking on the icon opens the app page dedicated to the virtual remote control**, which allows you to operate the caddy using your device.
- H. **Clicking on the icon opens the app setting page**
- I. **Caddy Information page.**

7.3 Virtual remote control

- 4. If your remote control is out of battery, you can operate the caddy using the virtual remote control in exactly the same way as with the joystick on the physical remote.
The movement controls are press-and-hold activated.



RANGE OF THE VIRTUAL REMOTE CONTROL



- The caddy's control range via the virtual remote is directly linked to the operational range of the Bluetooth connection. It is recommended not to exceed a distance of 10 yards from the caddy while using this mode.



7.4 Settings page

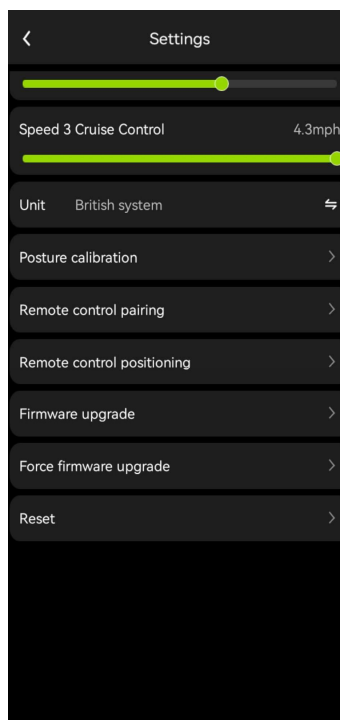
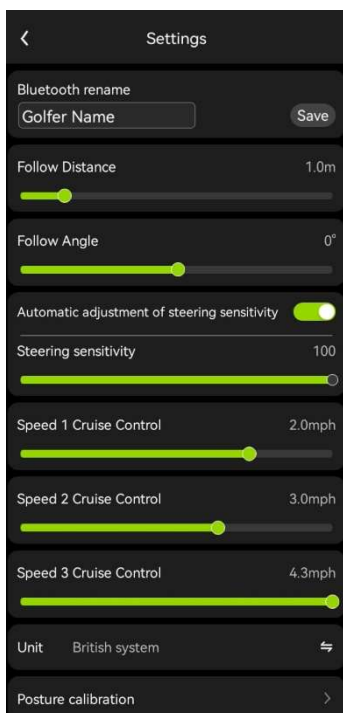

BLUETOOTH RENAME: Insert the caddy's or golfer's Name and press "Save"

FOLLOW DISTANCE: Setting the distance at which the caddy will follow you when the Follow Me mode is active. **NOTE: The unit of measurement for the following distance cannot be changed and is always displayed in meters. 1 meter is equivalent to 1.09 yards or 3.2 feet.**

FOLLOW ANGLE: Setting the angle at which the caddy will follow you when the Follow Me mode is active. With an angle greater than 0°, the caddy will always follow you on your right. With an angle less than 0°, the caddy will always follow you on your left.



AUTO STEERING SENSITIVITY: When enabled, it automatically adjusts the steering sensitivity in remote control mode based on the caddy's speed.

STEERING SENSITIVITY: Setting the sensitivity of the caddy's steering when using the joystick on the remote control. **NOTE: "0" Value mean less sensitive steering.**

SPEED CRUISE CONTROL 1,2,3: Setting the automatic forward speeds in cruise control mode.

NOTE: Speed Cruise Control 3 also serves as the reference speed for the caddy when used with the remote control or Follow Me mode.

UNIT: From this button, you can change the speed unit displayed on both the caddy and the app from km/h to miles per hour.

POSTURE CALIBRATION: Accessing the caddy calibration page **Note: Before calibrating the caddy (which is necessary if the caddy does not follow you correctly in Follow Me mode), activate the parking brake while the caddy is on a perfectly flat surface, and do not touch the caddy during the entire calibration process.**

REMOTE CONTROL PAIRING: Activate the remote control pairing procedure as shown in the dedicated chapter 6.3.1.

REMOTE CONTROL POSITIONING: Accessing the remote control positioning page. The remote control positioning page is only a diagnostic page showing the remote's position relative to the caddy's following sensor. No commands or actions can be performed from this page. Access to this page may be requested by customer support following a malfunction of the Follow Me mode.

FIRMWARE UPGRADE: Accessing the APP Firmware upgrade page (Action not recommended unless instructed by the manufacturer)



FORCE FIRMWARE UPGRADE: Action not recommended unless instructed by the manufacturer.

RESET: Factory reset and odometer reset. **NOTE:** Once the caddy is reset, the previous odometer and trip readings cannot be restored.

APP UPGRADE



- The app does not need to be updated unless specifically instructed by Green Eagle Golf. Forcing an update may cause the app to malfunction.

8 Maintenance

All these recommendations, together with common sense, will help keep your caddy in top condition and ensure its reliability over time.

To keep your caddy looking its best, wipe any mud or grass off the frame and wheels after each use, using a damp cloth or paper towel.

Never use water jets or pressure washers to clean the Caddy to prevent moisture from entering the electronic systems motors, or gearboxes.

Dry your caddy properly after each use.

Inspect your trolley carefully at least once a year and, if you notice any signs of wear or malfunction, contact GEEN EAGLE GOLF assistance to have them suggest the recommended intervention to guarantee a long life to your caddy.

8.1 Battery Maintenance

To preserve the battery's functionality, follow the instructions below:

- Do not expose the battery to liquids, humidity, or dust.
- Do not wash the battery.
- Do not drop the battery or strike it. You could irreparably damage the battery or cause internal damage that may lead to a fire or explosion.



- Do not store the battery when it is discharged.
- To clean the battery, use only a soft, dry cloth to remove any dust or dirt residue.

FIRE - EXPLOSION



- **Never leave the battery unattended while charging. The battery is equipped with a safety BMS that prevents overcharging. However, it is good practice to stay nearby during the charging process and, if possible, avoid charging the battery overnight.**
- **If you notice any swelling on the battery, immediately disconnect the battery charger and place the battery in an outdoor area. Then contact Green Eagle Golf customer service.**

BATTERY CHARGING TIPS



- **Always remove the battery from the caddy during charging. Failing to do so may cause inaccurate battery level readings on the caddy display.**
- **Connect the charger only to standard 110V residential power outlets.**



8.2 Troubleshooting guide

Trouble	Possible solution
Caddy does not power up	<ul style="list-style-type: none">• Make sure battery is correctly inserted into caddy.• Make sure battery is sufficiently charged. The correct battery voltage range is between 25 ÷ 29 V.• Press and hold power button for at least 3 seconds.• Make sure power button is engaging circuit board (you should hear a click).• Check charger function, output voltage from the charger should be 29,4 Volt.
The tiller does not lock in the desired position.	<ul style="list-style-type: none">• Make sure the tiller height adjustment knob is turned to the locked position. If the knob does not lock in the desired position, the adjustment mechanism may be damaged. Please contact customer support.
Motor is running but wheels don't turn	<ul style="list-style-type: none">• Check connection between wheels and motor.
Remote control doesn't work or doesn't charge	<ul style="list-style-type: none">• Check the battery charge.• Make sure the charger used for charging has an output of at least 3 Amps.• Try replacing the charging adapter with a different one.• Try replacing USB cable with a different one.• Perform the synchronization procedure described in § 6.3.1



Trouble	Possible solution
The caddy is not detected by the smartphone app.	<ul style="list-style-type: none">• Make sure Bluetooth on your device is turned on and allows discovery of other devices.• Make sure the caddy is turned on and that the Bluetooth indicator light is blinking.• Do not try to connect the caddy to multiple devices; it can only be connected to one device at a time. If you switch devices, you will need to turn the caddy off and on again, then re-pair the caddy with the smartphone.
The caddy doesn't follow correctly or suddenly changes direction.	<ul style="list-style-type: none">• Make sure the remote control is properly positioned on the back side of your body at waist level, using the provided clip.• Make sure not to place your body between the remote control and the golf caddy. There must be no obstacles in the line of sight between the remote control and the golf caddy.• Using the app, set the following distance between 2 and 3 meters. A following distance that is too short may sometimes cause communication issues.• Make sure the remote control is sufficiently charged.• Perform the posture calibration through the mobile app.



Trouble	Possible solution
The caddy is slow or has low traction.	<ul style="list-style-type: none">Using the smartphone app, set Cruise Control 3 to the maximum allowed speed. Cruise Control 3 also serves as the reference speed for the caddy when used with the remote control or Follow Me mode.
The speed adjustment potentiometer on the tiller is not working.	<ul style="list-style-type: none">Some electrical connections may have come loose. Please contact customer support for further assistance with troubleshooting the issue.
The wheel lock or marching mode does not activate.	<ul style="list-style-type: none">Some electrical connections may have come loose. Please contact customer support for further assistance with troubleshooting the issue.
The caddy is following me either too closely or too far away.	<ul style="list-style-type: none">Set the desired following distance through the mobile app by accessing the "Settings" page.
The front wheels move in a jerky/stuttering manner.	<ul style="list-style-type: none">Remove the cover on the top of the faulty wheel and properly tighten the nut. If the issue persists, please contact customer support.
The camera does not activate via the remote control.	<ul style="list-style-type: none">A smartphone app firmware update may be required. Please contact customer support.
The battery doesn't charge, or the charger LED stays green when the charger is connected to the battery.	<ul style="list-style-type: none">There may be a malfunction in either the charger or the battery itself. Try connecting and disconnecting the battery a couple of times. If the issue persists, please contact customer support.
The battery level indicated on the caddy is different from the one shown in the smartphone app.	<ul style="list-style-type: none">It is recommended to always remove the battery from the caddy during charging to prevent this potential issue.



9 Technical data

- Weight 40 lbs
- Motor: 80W Twin Motors
- Max Speed: 4,5 mph
- Max Load Capacity: 100 lbs
- Climbing Angle: 35°
- 4 Driving Modes: Follow mode, Remote/APP mode, Assisted mode, Manual mode.
- Brake function.
- Auto Balancing, Anti twist
- Downhill Auto-Brake System
- LCD display integrated
- Battery Type: Li-ion
- Battery Capacity: 25,2V/10,4Ah
- Distance per Charge: 28 mi
- Battery Life: 2000 charges
- Charging Time: 4-5 hours
- Size Folded: 28,5x24,5x14,5 in
- Size Unfolded: 43x24x36 in (adjustable)
- Shipping Box Weight: 48lbs
- Shipping Box Dimensions: 30.7×24.8×16.9 Inch



Customer service - technical assistance

In case of need to communicate malfunctions of your caddy or order spare parts not present on our e-commerce, contact GREEN EAGLE GOLF at **support@greeneaglegolf.com**. Please specify the order number, describe the nature of the problem, and send images or videos of the issue or malfunction.



Website: www.greeneaglegolf.com

E-mail: support@greeneaglegolf.com

Telephone: (786) 912-2571



[greeneagle_golf](https://www.instagram.com/greeneagle_golf)



[Green Eagle Golf](https://www.facebook.com/GreenEagleGolf)

This document and its contents are the property of Green Eagle Golf all rights are reserved and the contents cannot be reproduced, even partially, without written authorization from the manufacturer.